

MD17C

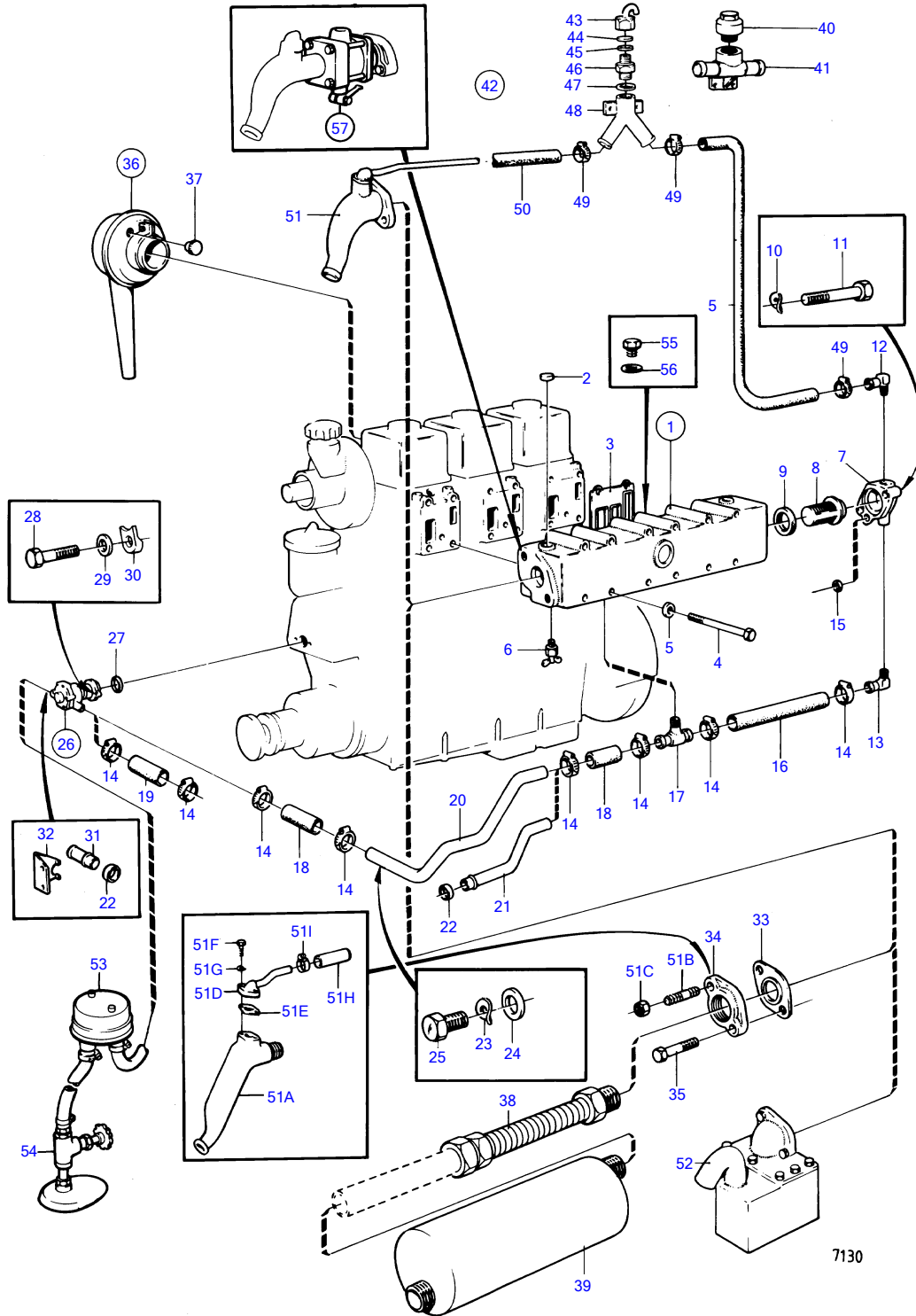

## MD17C

REF	PART NO.	QTY	DESCRIPTION	SEE SEC.	NOTES
1		1	EXHAUST MANIFOLD		REPLACED BY 829950., MO-16842
	829950	1	Exhaust pipe		MO 16843-
2	192211	5	• Expansion plug		
3	833598	3	Gasket		
4	940129	12	Hexagon screw		
5	955894	12	Washer		
6	829592	1	Drain cock		
7		1	THERMOSTAT HOUSING		REPLACED BY 897330 + 801197 + 955989., EARLY TYPE
	876080	1	Thermostat kit		LATE TYPE
8	876080	1	Thermostat kit		62°C
9	416033	1	Sealing ring		(418361) MO-16292
	416033	1	Sealing ring		MO 16293-
10	941907	2	Spring washer		
11	955299	2	Hexagon screw		
12	801197	1	Hose attachment		
13	945341	1	Hose attachment		EARLY TYPE
	801197	1	Hose attachment		LATE TYPE
14	943472	6	Hose clamp		
	943472	4	Hose clamp		SPEC 867423, -426, -428, -500., MD17D SPEC 867681, -682, -683.
15	955989	1	O-ring		
16	952969	X	Hose		L = 290 MM
17	833356	1	Hose attachment		OBSOLETE PART
18	952969	X	Hose		L = 2X70 MM
	952969	X	Hose		SPEC 867423, -426, -428, -500., MD17D SPEC 867681, -682, -683., L = 1X70 MM
19	952969	X	Hose		MD17C/HD-HY., L = 100 MM
20	833119	1	Tube		MD17C, MD17C/HD-BT, MD17C/HD-RB., MD17C/110S., OBSOLETE PART
	829897	1	Coolant pipe		SPEC 867423., OBSOLETE PART
	829896	1	Coolant pipe		SPEC 867426, -428, -500., MD17D SPEC 867681, -682, -683., OBSOLETE PART
	833744	1	Coolant pipe		MD3B SPEC 867119, 867231. MD17C SPEC 867211, 867340., SPEC 867423., OBSOLETE PART
21	829645	1	Coolant pipe		MD17C/HD-HY., OBSOLETE PART
22	418411	1	Sealing ring		MD17C/HD-HY.
	418411	2	Sealing ring		SPEC 867423, -426, -428, -500.
23	941906	1	Spring washer		MD17C/110S., MD17 SPEC 867423.
24	955892	1	Washer		MD17C/110S., MD17 SPEC 867423.
25	955273	1	Hexagon screw		MD17C/110S.
		1			SPEC 867428
26	825916	1	Water pump		REPLACED BY 829895 + 829901 + 829898 + 2EA 418411 + 2EA 833878.
			•	15111	
	829650	1	Water pump		MD17C/HD-HY., MD17C/110S., REPLACED BY 829895 + 829901 + 829898 + 2EA 418411 + 2EA 833878.
			•	15111	
	829895	1	Sea water pump		MD17C/HD-BT, MD17C/HD. SPEC 867500 MO17973-.
				15112	
	875698	1	Repair kit		FOR WATER PUMP 829895.
			•	15112	
27	925091	1	O-ring		
28	955272	2	Hexagon screw		MD17C, MD17C/HD-BT, MD17C/HD-RB.
	955274	2	Hexagon screw		MD17C/HD-HY., MD17C/110S., SPEC 867426, -428, -500.
29	11991	2	Gasket		MD17C, MD17C/HD-BT, MD17C/HD-RB.
	955892	2	Washer		MD17C/HD-HY., MD17C/110S., SPEC 867426, -428, -500.
	941906	2	Spring washer		MD17C/HD-HY., MD17C/110S., SPEC 867426, -428, -500.

7742230-26-15109

7130

Upd:2010-07-01

MD11, MD11C, MD11D, MD17, MD17C, MD17D



## MD17C

REF	PART NO.	QTY	DESCRIPTION	SEE SEC.	NOTES
30	833878	2	Clamp		MD17C/HD-HY., MD17C/110S., SPEC 867426, -428, -500., MD17D SPEC 867681, -682, -683.
31	829901	1	Connection pipe		SPEC 867423., SPEC 867426, 867428.
32	840194	1	Anchorage		SPEC 867423., SPEC 867426, 867428.
33	803374	1	Gasket		
34	807050	1	Exhaust pipe flange		
35	955319	2	Hexagon screw		
36	833414	3	Air filter		LATE TYPE, OBSOLETE PART
37	833546	3	• Plug		
38	833841	1	Compensator		DRY EXHAUST LINE., OBSOLETE PART
39	833840	1	Muffler, DRY		DRY EXHAUST LINE.
40		1	VACUUM VALVE		REPLACED BY 828263, 828262., EARLY TYPE
41		1	HOUSING		REPLACED BY 828263, 828262., EARLY TYPE
42	828534	1	Vacuum valve		(828263)
43		1	• UPPER UNIT		
44		2	• Diaphragm		
45	828424	2	• Gasket		
46		1	• LOWER PART		
47	947282	2	• Gasket		
48	828262	1	Hose connection		LATE TYPE
49	961666	4	Hose clamp		
50	13569	X	Hose		
51	833586	1	Exhaust bellows		SEE GROUP 9, OBSOLETE PART
51A	833998	1	Exhaust riser		MD17D SPEC 867681, -682, -683., MD17C SPEC 867500.
51B	924079	2	Stud		MD17D SPEC 867681, -682, -683., MD17C SPEC 867500.
51C	955783	2	Hexagon nut		MD17D SPEC 867681, -682, -683., MD17C SPEC 867500.
51D	833422	1	Coolant pipe		MD17D SPEC 867681, -682, -683., MD17C SPEC 867500., OBSOLETE PART
51E	800326	1	Gasket		MD17D SPEC 867681, -682, -683., MD17C SPEC 867500.
51F	955275	2	Hexagon screw		MD17D SPEC 867681, -682, -683., MD17C SPEC 867500.
51G	941906	2	Spring washer		MD17D SPEC 867681, -682, -683., MD17C SPEC 867500.
51H	952969	X	Hose		MD17D SPEC 867681, -682, -683., MD17C SPEC 867500., L = 55 MM
51I	943472	1	Hose clamp		MD17D SPEC 867681, -682, -683., MD17C SPEC 867500.
52	828064	1	Muffler		SEE GROUP 9, LATE TYPE
53	831733	1	Strainer		SEE GROUP 9
54	828242	1	Cooling water inlet		SEE GROUP 9
55	960630	1	Plug		FOR EXHAUST MANIFOLD 829950.
56	957178	1	Gasket		FOR EXHAUST MANIFOLD 829950.
57	829986	1	Exhaust brake		SEE GROUP 9, OBSOLETE PART
			REGULATOR KIT		
			EXHAUST PRESSURE REGULATOR AND CONTROLS		SPEC 867426, 867428, SEE GROUP 2D